



SOLAR STIK®

**OPERATOR AND MAINTENANCE MANUAL  
FOR THE  
SOLAR VENTURE 300W  
PHOTOVOLTAIC ARRAY**



P/N 19-1000010



DISTRIBUTION STATEMENT A. Approved for public release; distribution is unlimited.

Version 1.0

Updated:2020108

October 2020

# Contents

## GENERAL INFORMATION, THEORY OF OPERATION, AND EQUIPMENT DESCRIPTION

<b>Introduction</b>	<b>4</b>
<b>Product Safety Information and Instructions</b>	<b>5</b>
Safety Information Labels	5
Fire Hazard	6
Recommended Fire Extinguisher	6
Electric Shock Hazard Related to PV Panels	7
<b>Environmental and Handling Precautions</b>	<b>8</b>
Wind	8
Water	8
Impact	8
Dust	8
Heat	8
<b>Theory of Operation</b>	<b>9</b>
<b>Equipment Description</b>	<b>10</b>
Kit Components	10

## OPERATOR INSTRUCTIONS

<b>Solar Venture 300W PV Array Setup</b>	<b>11</b>
Position and Orient System Components	11
Deploy the PV Array Support Frame	12
Install the Large Ground-securing Mesh	13
Install the Small Ground-securing Mesh	14
Install the PV Array on the Support Frame	16
Connect the Solar Cable to the PV Panel Leads	17
Connect PV Array(s) to Solar Only Input Port of Power Hub	18
<b>Position the PV Arrays for Optimal Power Generation</b>	<b>19</b>
<b>Derating, Solar Loading, and Airflow</b>	<b>19</b>
<b>Secure the Array to the Ground</b>	<b>20</b>
<b>Disassembling and Repacking the PV Array</b>	<b>21</b>

## MAINTENANCE

<b>Preventive Care and Maintenance</b>	<b>22</b>
<b>PV Array Conditional Maintenance</b>	<b>22</b>
<b>Measuring PV Array Voltages: Background</b>	<b>22</b>
Procedure to Measure PV Array $V_{oc}$ with a Multimeter	23

## SUPPORTING INFORMATION

<b>Technical Specifications</b>	<b>24</b>
---------------------------------	-----------

## ABOUT SOLAR STIK, INC.

<b>Contact</b>	<b>27</b>
----------------	-----------

## List of Figures

Figure 1. Solar Venture 300W PV Array with ground securing .....	4
Figure 2. Solar Venture 300 W PV array with a small HPS .....	9
Figure 3. Solar Venture 300W PV Array components in transport case (top) and unpacked (bottom) .....	10
Figure 4. Working-space radius for the PV arrays and associated equipment .....	11
Figure 5. Deploying the PV array support frame .....	12
Figure 6. Large ground-securing mesh installation .....	13
Figure 7. Small ground-securing mesh installation .....	14
Figure 8. Ground-securing mesh configuration for 30° array deployment .....	15
Figure 9. Ground-securing mesh configuration for 60° array deployment .....	15
Figure 10. Connecting array hooks to support frame.....	16
Figure 11. Locking the array into place on the support frame .....	16
Figure 12. Connecting the PV array to the Solar Cable.....	17
Figure 13. PV arrays connected to Solar Only Input ports of Power Hub .....	18
Figure 14. Ground-securing sandbag placement .....	20
Figure 15. Packing the Solar Venture 300W PV Array .....	21
Figure 16. Measuring PV array open circuit voltage $V_{oc}$ .....	23

## Revision History

Section	Page(s)	Description	Date
		Published	June 2020

# GENERAL INFORMATION, THEORY OF OPERATION, AND EQUIPMENT DESCRIPTION

## Introduction

The Solar Venture 300W Photovoltaic (PV) Array is designed to generate renewable power in expeditionary applications where weight, rugged design, and extreme portability are factors.

The Venture design can be deployed on any terrain, and the PV array can generate up to 300 Watts of power for applications where independence from traditional power sources is required:

- PV power generation for remote locations where fuel-driven generators are not an option
- Decreased fuel consumption in a Hybrid Power System (HPS)
- Peak-shaving to decrease reliance on power from utility or grid

The Solar Venture 300W PV Array is modular and scalable, allowing users to tailor power generation capability to load requirements.

Setup requires no tools and the 300 W Array is “Plug & Play” compatible with Hybrid Power Systems.

The mono-crystalline cells in the high efficiency Venture-Series panels are laminated onto a carbon-fiber structure, which combines extremely high PV performance with incredibly light material for an extraordinary watt-to-weight ratio. The Venture offers a superior integration of technologies to provide the operator with highest power in the smallest renewable generator footprint.



Figure 1. Solar Venture 300W PV Array with ground securing

## Product Safety Information and Instructions

This manual contains important safety instructions that must be followed during the installation and operation of the PV array. Read all instructions and safety information contained in this manual.

Exercise caution when handling or operating equipment. Live power may be present.

### Safety Information Labels

Your safety and the safety of others is very important. This manual provides guidance on safe operating practices and how to achieve maximum performance from the Solar Venture 300W PV Array. Always observe and follow all safety protocols outlined below:



This is the safety alert symbol. This symbol alerts you to potential hazards that can kill you or hurt you and others. All safety messages will follow the safety alert symbol and the word “DANGER”, “WARNING”, or “CAUTION”. These words are defined as:



Indicates a hazardous situation which, if not avoided, **will result in death or serious injury**.



Indicates a hazardous situation which, if not avoided, **could result in death or serious injury**.



Indicates a hazardous situation which, if not avoided, **could result in minor or moderate injury**.

All safety messages will identify what the potential hazard is, how to reduce the chance of injury, and what can happen if the instructions are not followed.

## Fire Hazard

### Fire Types

**Class A fire** - Fires in ordinary combustibles such as wood, paper, cloth, trash, and plastics.

**Class B fire** - Fires in flammable liquids such as gasoline, petroleum, oil, and paint.

**Class C fire** - Fires involving energized electrical equipment such as motors, transformers, and appliances. Remove the power source and the class C fire becomes a class A or B fire.

### Recommended Fire Extinguisher

NSN 4210-00-288-7219 Fire Extinguisher, Carbon Dioxide, 10 lb

Carbon dioxide is a liquefied gas, which is highly effective fighting class B and C fires. These extinguishers are ideal for areas where contamination and/or cleanup are a concern, such as data processing centers, labs, and telecommunication rooms.

**WARNING**

Only CO<sub>2</sub> (carbon dioxide) fire extinguishers should be used with this equipment.



### Using the Fire Extinguisher

When using the extinguisher on a fire, remember PASS:

**P**ull the pin.

**A**im the nozzle or hose at the base of the fire from a safe distance.

**S**queeze the operating lever to discharge the fire extinguishing agent.

**S**weep the nozzle or hose from side to side until the fire is out. Move forward or around the fire as the fire diminishes.

Watch the area for reignition until the cause has been fixed.

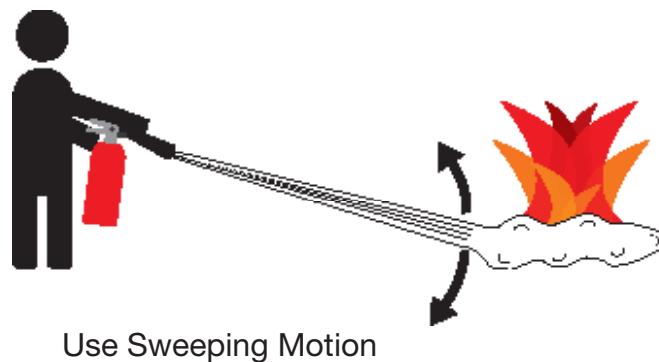

## Electric Shock Hazard Related to PV Panels

### **⚠ WARNING**

Standing water around the electrical equipment and/or intrusion of water into the System components can increase the risk of electrical shock.

- PV panels produce electricity when exposed to sunlight.
- Live power may be present at multiple terminals.
- Never route the cables through standing water.
- All cables and connections should remain dry and should be inspected regularly to ensure safe operating conditions.

**DON'T LET THIS BE YOU!**



**HIGH VOLTAGE:** PV arrays and generators produce potentially lethal line voltages. When servicing equipment, extreme care should be taken to protect against electrocution. Always work with another person in case an emergency occurs. Disconnect power before checking controllers or performing maintenance. Be sure the generator is properly grounded. Wear safety glasses whenever working on any part of the System that requires exposure to mechanical or direct electrical contacts.



## Environmental and Handling Precautions

This equipment is ruggedized, yet there are a few things the operator can do to prevent failures and prolong the operational life of the product.

### Wind

It is imperative to properly secure the PV panels to the ground using sandbags so they do not become dangerous projectiles in high winds.



### Water

- Do not operate equipment in or around standing water.
- Do not place cables that conduct electricity in or near standing water.

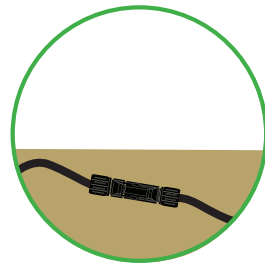

### Impact

The PV panels should be protected from being struck by hard objects.

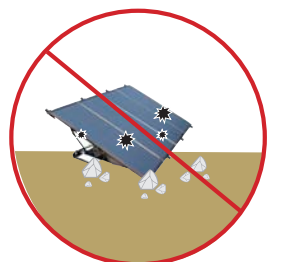
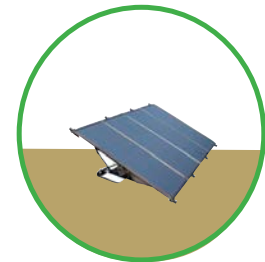

### Dust

- This equipment is designed for operation in climates where high levels of dust or other particulates may exist.
- Clean the surface of the PV panels regularly to maintain maximum output. Dirty panels produce less power.

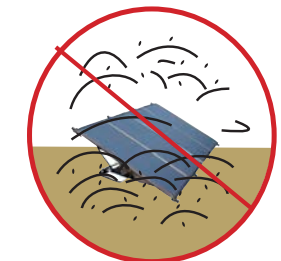
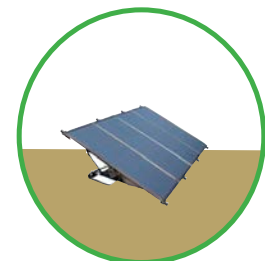

### Heat

- Heat and solar loading reduce efficiency and life expectancy. Shade products (except PV panels) to prevent the negative effects of heat.
- PV panels should be placed so that they are exposed to adequate airflow.

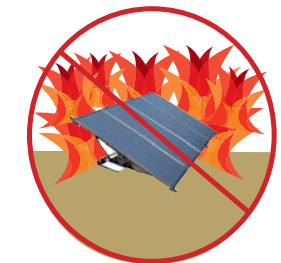
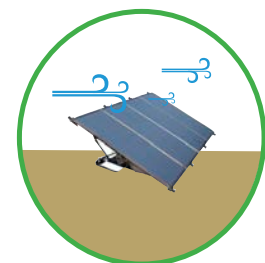



## Theory of Operation

PV cells convert sunlight into electrical power. All PV cells are made of materials called semiconductors that absorb photons when sunlight strikes the PV cell. The absorbed photons then knock electrons loose within the PV cells, allowing them to flow, which produces an electrical current. PV cells contain one or more electric fields that force the direction of electron flow. Placing metal contacts on the top and bottom of a PV cell harnesses this current so it can power external appliances, much like a traditional power generator.

On their own, PV cells produce a limited amount of power, but when arranged and electrically connected in a PV panel, the power generated is directly related to how much cumulative current and voltage the PV cell arrangement is configured for. The panel's total output voltage and current will determine its "watt" rating.

The cell configuration of the Venture 300 Array generates up to 300 W of DC power for an application.



Figure 2. Solar Venture 300 W PV array with a small HPS

# Equipment Description

## Kit Components



Solar Venture 300W PV Array	
1	Hard transport case
2	4-section foldable PV array
3	Ground-securing mesh (large and small)
4	Support frame
5	Sandbags (12 ea)
6	Solar Cable (sold separately)

Figure 3. Solar Venture 300W PV Array components in transport case (top) and unpacked (bottom)

# OPERATOR INSTRUCTIONS

## Solar Venture 300W PV Array Setup

### Position and Orient System Components

Identify the best location for each component of the System, keeping in mind the length of all cables that will be used to connect all of the components. The typical Solar Cable provided is 30' long (other lengths are available).

The PV array can be deployed within a 30' radius (the length of the Solar Cable) of the component to which it will be connected. If the PV array must be deployed more than 30' from the Power Pak or Power Hub, etc., extensions are available.

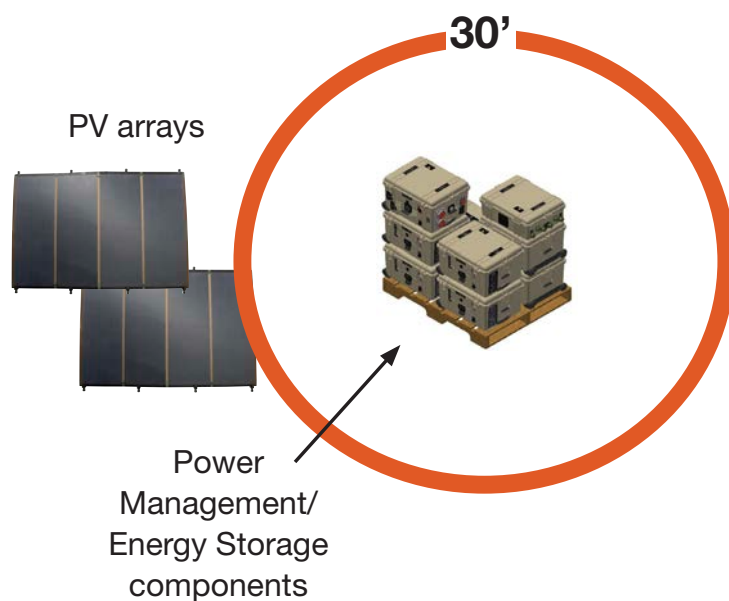

Figure 4. Working-space radius for the PV arrays and associated equipment

## Deploy the PV Array Support Frame

Loosen the transport strap securing the foldable array support frame (Figure 5A). Remove the two locking pins (Figure 5B) to allow the frame to expand. Expand the support frame (Figure 5C) and install the locking pins in the “deployed” position (Figure 5D) after the support frame is fully extended (Figure 5E).

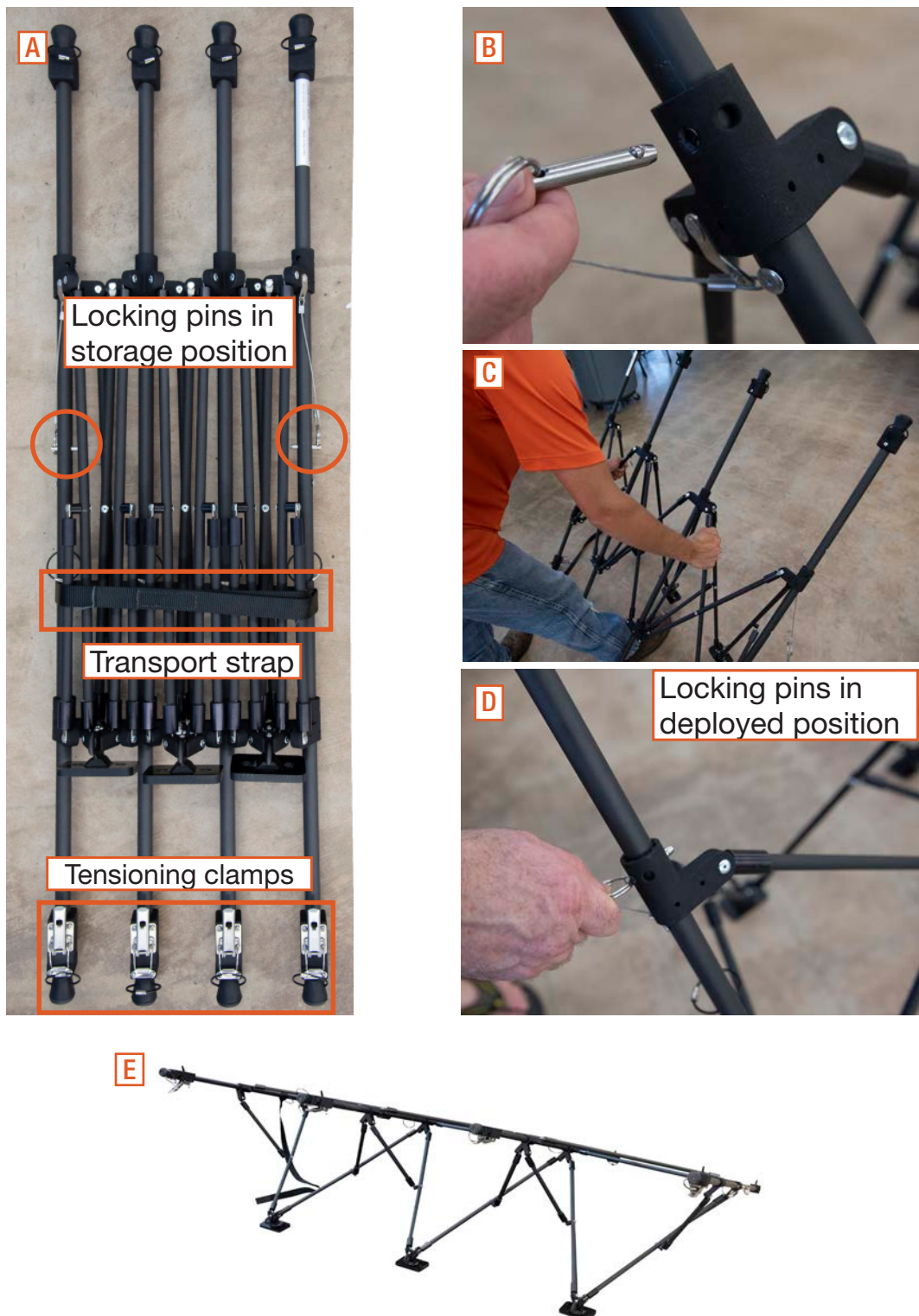

Figure 5. Deploying the PV array support frame



## Install the Large Ground-securing Mesh

The large ground-securing mesh has three (3) clips on the short side and four (4) on the long side (Figure 6A). The clips on the short side connect to the rings on the three (3) cleats (Figure 6B) of the support frame. Connect the four (4) clips on the long side of the ground-securing mesh to the wire loops (Figure 6C) at the low end of the support frame bar (Figure 6D). The mesh will be stretched tight when all of the connections are made.

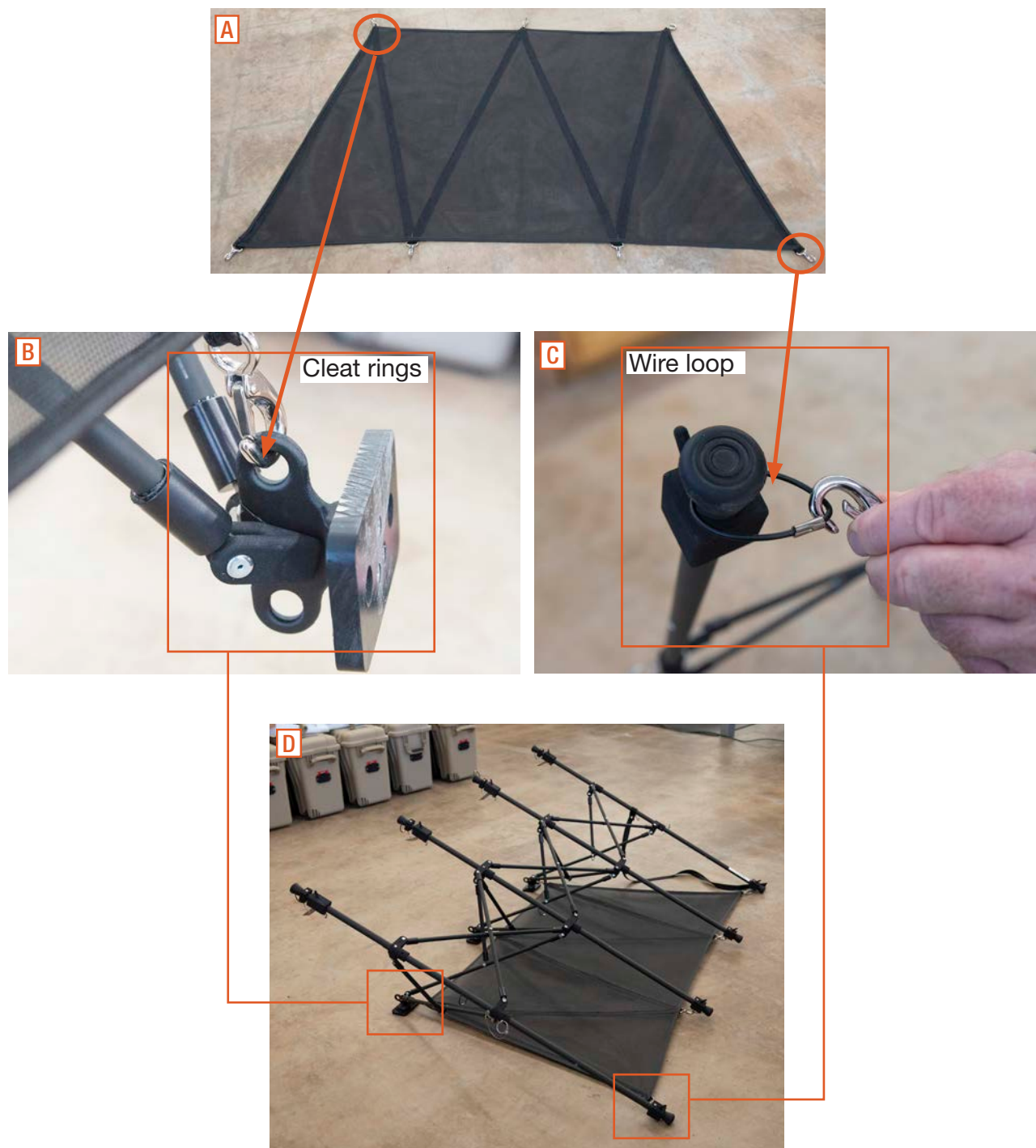

Figure 6. Large ground-securing mesh installation

## Install the Small Ground-securing Mesh

The small ground-securing mesh has three (3) clips on the short side and four (4) on the long side (Figure 7A). The clips on the short side connect to the rings (Figure 7B) on the three (3) cleats of the support frame (Figure 7C).

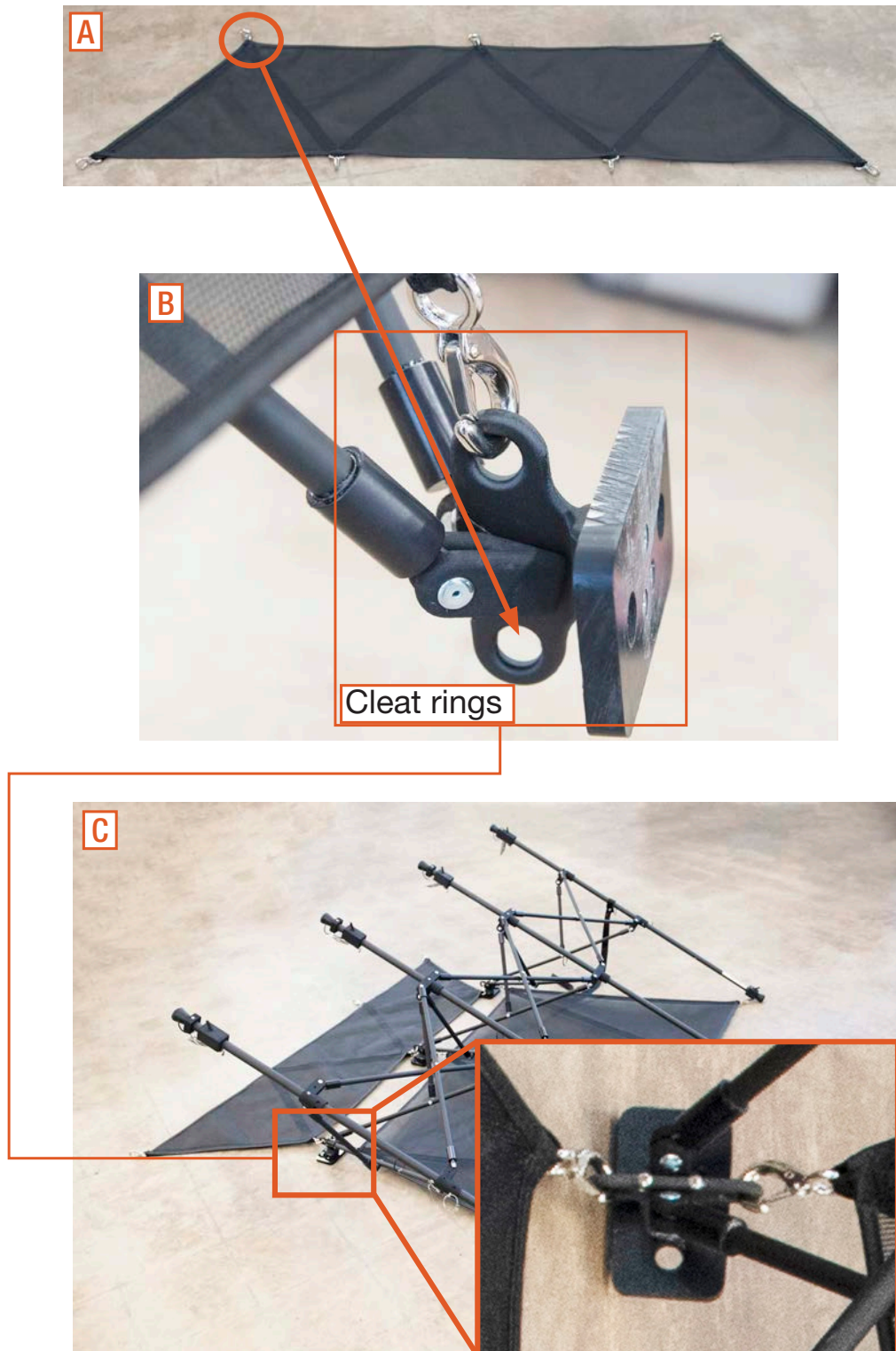

Figure 7. Small ground-securing mesh installation

## Ground-securing Mesh Configuration for Low- and Steep-angle Deployments

Connect the large and small ground-securing meshes as shown in Figure 8 to deploy the PV array at 30° and as shown in Figure 9 to deploy the PV array at 60°.

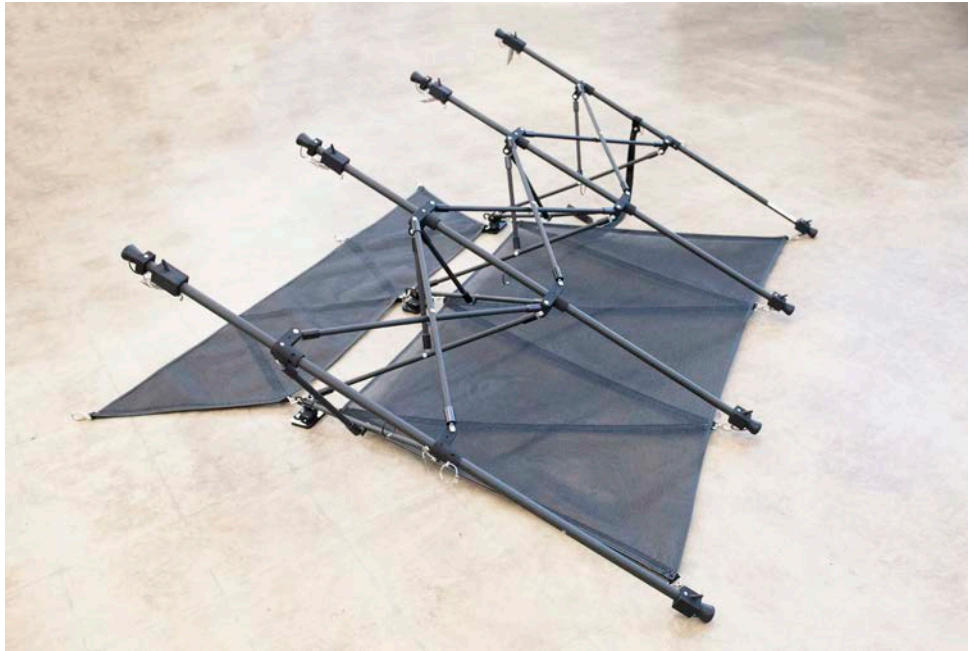

Figure 8. Ground-securing mesh configuration for 30° array deployment



Figure 9. Ground-securing mesh configuration for 60° array deployment



## Install the PV Array on the Support Frame

The PV array has eight (8) grommet-reinforced holes, four (4) on the top and four (4) on the bottom (Figure 10A, orange circles). The support frame has eight (8) complementary panel mounting hooks (Figure 10B, orange circles). Connect the bottom of the PV array to the lower row of mounting hooks first and the top row of hooks second (Figure 10B).

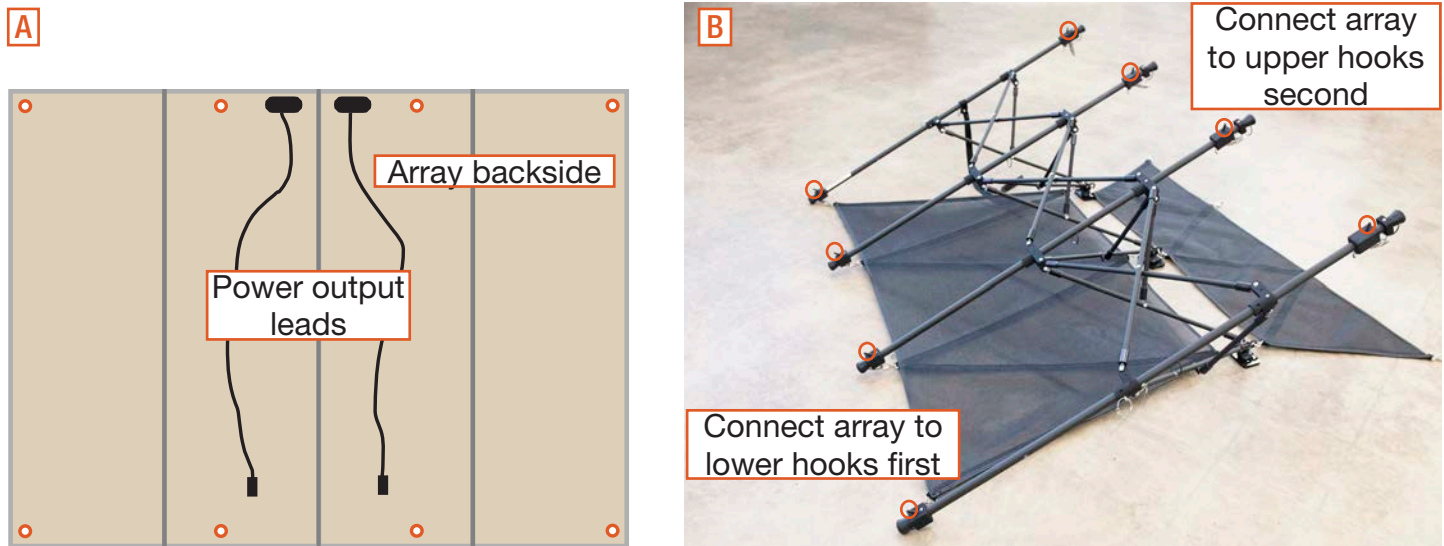

Figure 10. Connecting array hooks to support frame

The hooks on the upper row are part of a sliding tensioning clamp. Unlock and lift the clamp lever to allow the hook to slide down (Figure 11A). Place the hook into the hole, then tighten (Figure 11B) and lock the clamp (Figure 11C). Repeat for each of the four mounting holes until the array is secured to the support frame (Figure 11D).

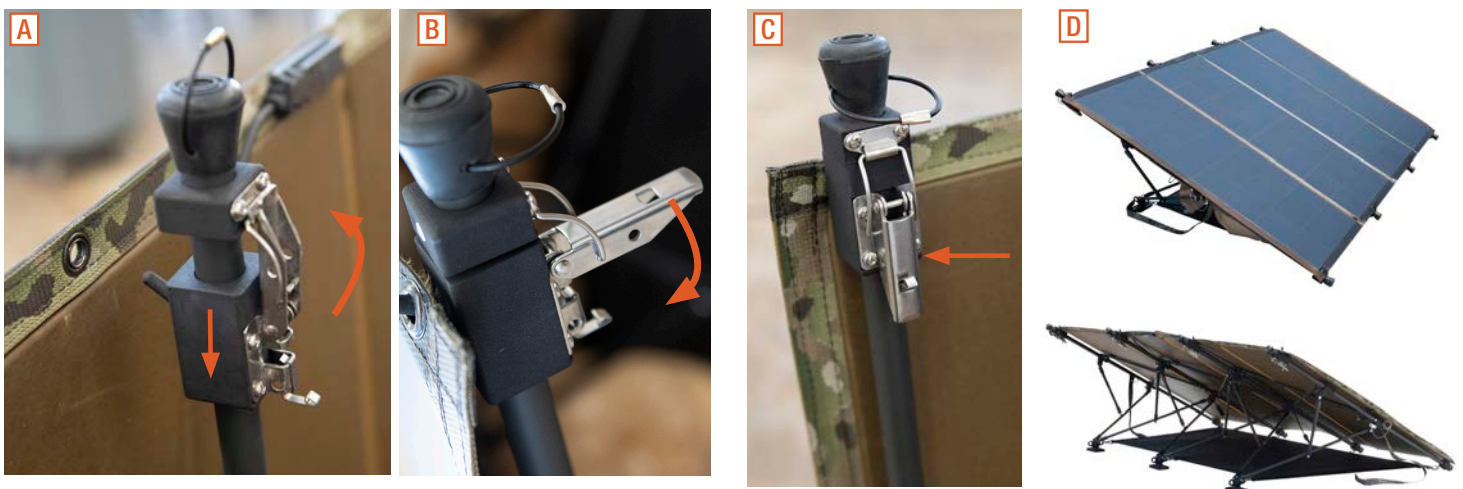

Figure 11. Locking the array into place on the support frame

## Connect the Solar Cable to the PV Panel Leads

Connect the leads on the PV array (Figure 12A) to the Solar Cable (Figure 12B). The locking connectors are polarized (Figure 12C–D).

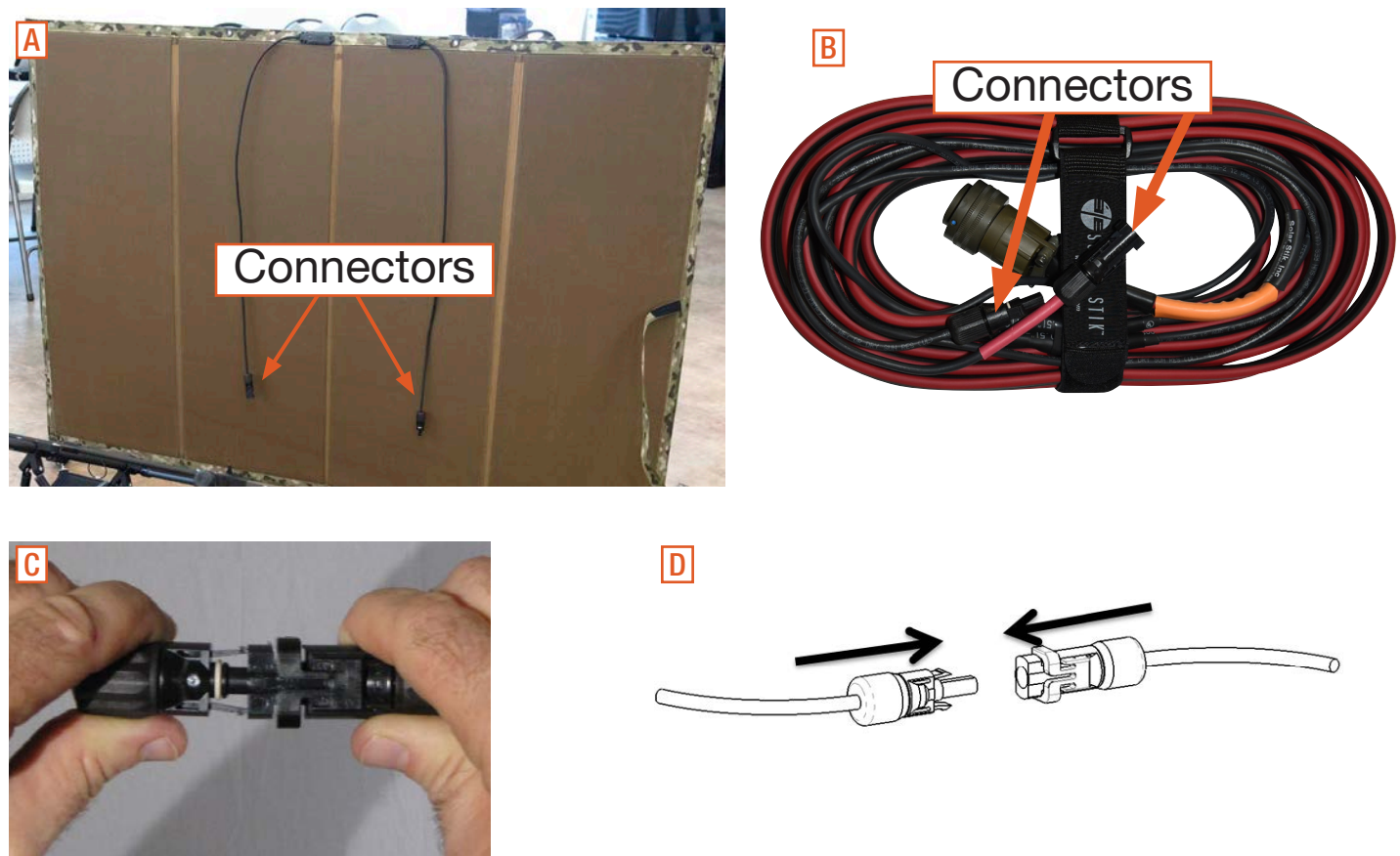

Figure 12. Connecting the PV array to the Solar Cable.

## Connect PV Array(s) to Solar Only Input Port of Power Hub

Note: This example describes connection to a Power Hub however, other Solar Stik components such as the PRO-Verter S, Power Paks and BOS have PV-input capabilities. Consult the Manuals for these components for details.

Connect the Solar Cable(s) to the Solar Only Input ports on the side of the Power Hub. A maximum of six (6) PV arrays can be connected to the Power Hub.

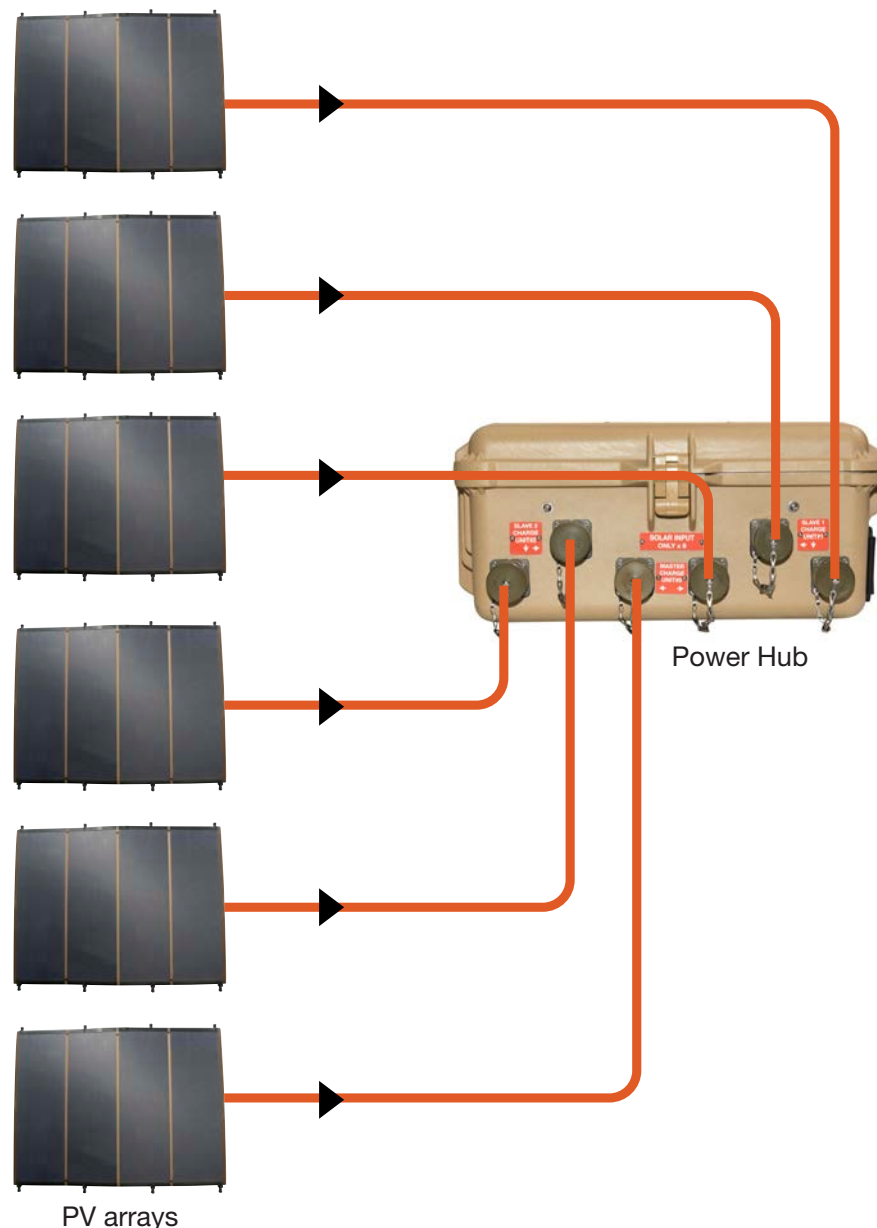

Figure 13. PV arrays connected to Solar Only Input ports of Power Hub

### NOTICE

Do not secure the PV array to the ground until adequate cable length to the Power Hub has been verified and the arrays have been oriented optimally toward the sun.

## Position the PV Arrays for Optimal Power Generation

### NOTICE

The setup location should have good exposure to sunlight and be away from other structures or potential hazards such as moving-vehicle thoroughfares.

### PV Array Orientation for Optimum PV Power Generation

PV generation requires direct sunlight for maximum performance. Optimal PV power generation is achieved by orienting all PV arrays in the same direction and at the same angle.

**Note:** Harvesting PV energy will not improve by orienting subsets of PV arrays to capture morning, midday, and evening sun. In the Northern Hemisphere, the PV arrays should be positioned so that they face the noon sun, which is usually true South, true North if in the Southern Hemisphere. The PV arrays may be deployed flat, aimed straight up if at or near the equator.

### Seasonal Adjustment of the PV Array Tilt to Improve Output

The PV array performance may be improved by adjusting the tilt and orientation of the panels seasonally. The angle of the array, relative to the sun, can be adjusted to 30° or 60° prior to securing to the ground. The sun is higher overhead during the summer and lower on the horizon during the winter.

Power output of the PV arrays can be monitored in real time on the Power Hub User Interface. (See the Power Hub Operator Manual for instructions.) Monitoring the power output while orienting and choosing the best tilt angle for the panels will assist in finding and maintaining optimum power output throughout the year.

### Shading

The PV arrays must be positioned so they are not shaded. During periods of inclement weather or if the array is not positioned optimally, daily power generation levels may be reduced.

## Derating, Solar Loading, and Airflow

Derating occurs when the power output of the PV arrays is diminished below their rated values. PV arrays may accumulate excessive amounts of heat due to solar loading and lack of airflow, resulting in derating.

Locate PV arrays where airflow is unobstructed to reduce the impact of solar loading-induced derating.



## Secure the Array to the Ground

Do not secure the arrays to the ground before establishing proper location and orientation.

### **! WARNING**

Failure to properly secure the PV array(s) to the surface with sandbags could result in PV array damage, injury, or death in high winds. Wind damage can render arrays nonfunctional or significantly reduce their functional life expectancy. PV arrays must be properly secured to the ground even in low-wind environments.

The PV array must be secured with three (3) to six (6) sandbags (Figure 14) to reduce the potential for damage in high winds.

Sandbags should weigh a minimum of 50 pounds (23 kg) each. Place sandbags on the large ground-securing mesh under the PV panel and on the small ground-securing mesh behind the panel as shown below (Figure 14).

### **! CAUTION**

**DO NOT DAMAGE THE ARRAY SUPPORT FRAME.**  
**DO NOT DROP SANDBAGS ONTO THE PV ARRAY SUPPORT FRAME.**



Figure 14. Ground-securing sandbag placement

**Note:** Before the arrays are secured to the ground, be observant and take care to ensure the support frame is not twisted. If the support frame is twisted, the array will be exposed to torsional strain, which can cause damage to the cells of the array panel(s).

## Disassembling and Repacking the PV Array

Repacking the PV array is safe and simple when done correctly. Please follow the instructions below. Failure to follow the instructions may result in damage to the PV array and difficulty fitting all of the pieces back into the transport case.

- Disconnect the PV array from the Power Hub, Power Pak or PRO-Verter S.
- Carefully clean the surface of the PV array.
- Remove the PV array from the support stand.
- Fold the PV array as shown in Figure 15 A.
- Place the folded PV array into the transport case and cover it with the case foam.
- Remove the locking pins (deployed position) from the PV array support frame, collapse/fold the support frame and return the locking pins to the storage position.
- Fasten the transport strap
- Place the support frame into the transport case on top of the case foam (Figure 15 B).
- Place the ground-securing mesh and the Solar Cable on the right and left sides of the interior (Figure 15 C).
- **The case lid should close without resistance when all components are stowed properly.**



Figure 15. Packing the Solar Venture 300W PV Array

# MAINTENANCE

## Preventive Care and Maintenance

- Ensure the PV panels are clean and positioned for maximum daily sunlight exposure.
- Secure the Solar Cables and provide strain relief at locations where the cables are stressed.
- Check the integrity of electrical connectors monthly.

## PV Array Conditional Maintenance

The Solar Venture 300W PV array(s) will typically be connected to a Power Hub to provide regulated power to an HPS. The Power Hub User Interface reports an extensive set of PV performance metrics including a daily and overall historical reports for each of the charge controllers in the Power Hub. These values should be monitored regularly during normal operation.

If an equal number of PV arrays is attached to each of the Power Hub charge controllers, the performance values reported by each charge controller on the Power Hub User Interface, both current and historical, should be approximately equal. This is an indication that all of the connected arrays are performing normally. If these values are not equal, one or more of the PV arrays may be under performing.

If a disparity in performance is observed during normal operation, measure the voltage of each array independently using a handheld multimeter (Figure 16) or the meters provided in the Power Hub User Interface.

**Note:** The charging current from the PV arrays as reported by the Power Hub User Interface will be low, even in full sun, when the System batteries are near to or at a full charge. This is a normal operating condition. Consult the System manual for information about using a specific Power Hub for array maintenance monitoring.

## Measuring PV Array Voltages: Background

Voltage “open circuit” ( $V_{oc}$ ) is unregulated PV array voltage and measured directly from the leads of an array when not connected to a “load” such as a charge controller (Power Hub). The rated  $V_{oc}$  of the Solar Venture 300W PV Array is approximately 65 V under standard test conditions (STC).

When the array is connected to the Power Hub (i.e., the array is connected to a “load”), it is more likely the operator will see voltages around 45–53  $V_{mp}$  reported on the User Interface.

The  $V_{oc}$  and  $V_{mp}$  should be measured for each PV array in “ideal” conditions if possible. This means the arrays should be oriented directly at the sun and unshaded on a clear day to identify the maximum  $V_{mp}$  and  $V_{oc}$ .



## Procedure to Measure PV Array $V_{oc}$ with a Multimeter

- Carefully place the leads of the voltmeter on pins A and C in the bayonet connector (Figure 16) at the end of the Solar Cable. Pin B is unused.
- Alternatively, disconnect the Solar Cable from the array leads and place the meter probes into the array lead connectors (orange boxes in Figure 16).

Under ideal conditions, the reading should be ~65 V. If a normal voltage reading cannot be measured at pins A and B of the Solar Cable but CAN be measured at the PV array lead connectors, replace the Solar Cable.

Contact Solar Stik if a PV array voltage measurement indicates that a PV array is either not functioning or is performing very poorly.

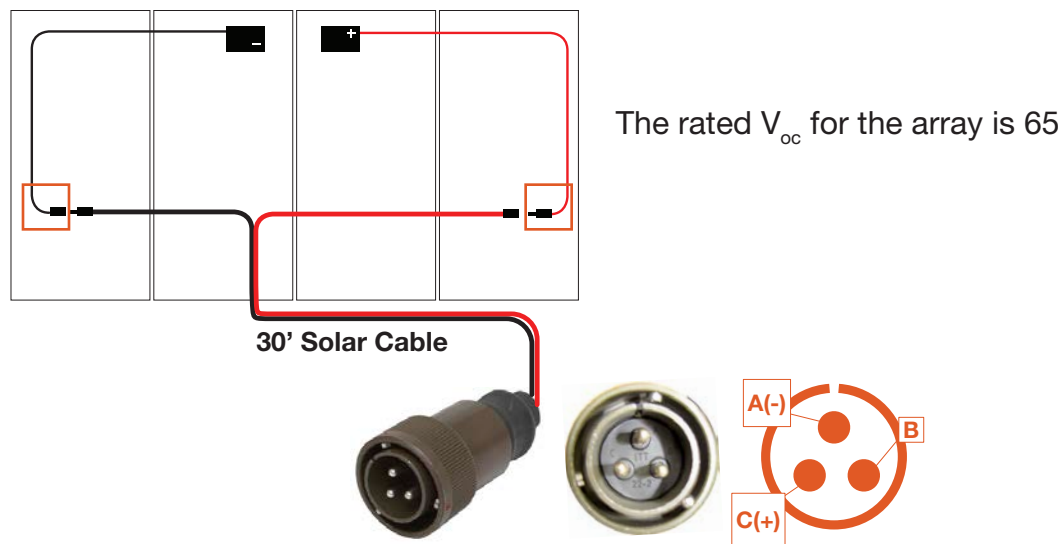

Figure 16. Measuring PV array open circuit voltage  $V_{oc}$

## SUPPORTING INFORMATION

### Technical Specifications

General	
Frame Construction	Anodized aluminum, stainless steel, and carbon fiber composites
Frame Adjustment Angles	30° and 60°
Solar Panel Construction	Tan fabric and carbon fiber
Ground Securing	Mesh and Sandbags
Setup/Stowage Time	3-5 minutes
Transport Case	SKB iSeries 4719-8 waterproof utility case with wheels
Warranty	1-year materials and workmanship

Array Performance Specifications (@ 77 °F / 25 °C)	
Max Power ( $P_{max}$ )	$\geq 300$ W
Rated Voltage ( $V_{mp}$ )	59.6 V
Open Circuit Voltage ( $V_{oc}$ )	65.2 V
Rated Current ( $I_{mp}$ )	5.51 A
Short Circuit Current ( $I_{sc}$ )	6.28 A
Cell Type	Monocrystalline silicone
Cell Efficiency (%)	> 22.4%

Environmental	
Operating Temperature	-40 to 194 °F (-40 to 90 °C)
Storage Temperature	-40 to 194 °F (-40 to 90 °C)
Operating Humidity	0 to 95% RH up to 140 °F (60 °C)
Ingress Protection	MIL-STD-810 Method 512, Procedure I, Immersion MIL-STD-810 Method 510, Procedure I, Blowing Dust
Loose Cargo	MIL-STD-810, Method 514, Procedure II
Transit Drop	MIL-STD-810, Method 516, Procedure IV
Vibration	MIL-STD-810, Method 514, Procedure I, Category 20

## Technical Specifications

Weights and Dimensions (L x W x H)	
PV Array Weight	15.0 lb (6.8 kg)
Assembled Weight	23.6 lb (10.7 kg)
Transport Weight	45.6 lb (20.7 kg) 53.1 lb (24.1 kg) with 30 ft Solar Cable
Solar Array Dimensions	Assembled: 65 x 43 x 0.2 in (165 x 109 x 0.5 cm) Folded: 16 x 43 x 1.5 in (41 x 109 x 3.8 cm)
Assembled Dimensions	65 x 48 x 4 in (165 x 122 x 10 cm)
Transport Dimensions	Case external: 49.7 x 21.5 x 8.87 in (126 x 54.6 x 22.5 cm)

Connections	
Solar Array Connectors	MC4



## ABOUT SOLAR STIK, INC.



SOLAR STIK®

### Mission Statement

Using American-made components and constant innovation, Solar Stik creates portable power solutions that enable self-sufficiency for the soldier, the sailor, and beyond. In doing so, we save lives, change lives, and help revive American manufacturing.

### STIKopedia

[STIKopedia](#) is a compilation of everything you would ever want to know about portable Hybrid Power Systems, including the philosophy and mechanics of high-efficiency circuits, and the individual technologies used to create them.

### Solar Stik Training and Education

- **Solar School (St. Augustine, FL)** provides an introduction to the design and support of small-scale, renewable-energy, power generation systems, with detailed explanation of system components. Advanced configuration options with hands-on deployment of actual systems will enhance student understanding.
- **Solar Stik New Equipment Training (on site)** teaches Hybrid System configuration options with hands-on deployment of actual systems to enhance student understanding.

Solar Stik Training Courses are tailored to the specific needs of the students. To schedule Solar Stik Training or to learn more about the curriculum, please contact us.

### Contact

#### Technical Support Line

800-793-4364 Ext. 102

(24 hours a day, 365 days a year)

#### Address

Solar Stik, Inc.

226 West King Street

Saint Augustine, Florida 32084

#### Website

[www.solarstik.com](http://www.solarstik.com)

Trademarks and Logos are the property of Solar Stik, Inc. unless otherwise noted.

This manual is subject to revisions without prior notice.

Copyright 2020 Solar Stik, Inc.

All Rights Reserved.